



## FlexMax AutoTalk Information

### AutoTalk is an Upgrade Option

The AutoTalk feature is not a standard feature, it's available for an extra charge after purchase. Use the *Upgrade My Controller* option in the *Tools* menu of our free Director software to see pricing and instructions on how to add this feature to your controller.

### Setting the AutoTalk Output

Once the feature has been added to your controller you have to select the mouth output. See the Mouth Output option in the Show Settings menu on the ScareMaster or Director software to set the output.

### How It Works

The controller monitors the audio level at the left channel of the Line In jack. As the audio passes above and below certain thresholds it turns your selected output off and on. It does some smoothing and filtering to prevent the output from turning off and on too quickly so it looks more natural. Changing the level of the audio sent to the BooBox is how you adjust the sensitivity of the mouth.

### Pneumatic Setups

Having precise control over the speed of the mouth is essential. We highly recommend speed control elbows at the top and bottom of the mouth cylinder so you can tune the speed in each direction. Set the speeds to be as fast as possible while still looking natural for a character of that size. Obviously you don't want the mouth to move so fast that it slams closed, but it does have to close fairly quickly or the operator will have to talk too slow. Cylinders with internal bumpers might allow for faster movement while also preventing unwanted noise and vibration.

## Example Audio Diagram Features

The example diagrams on the following pages each have pros and cons. They each support different combinations of the three key features below. Figure out which of the three features you need, then pick a diagram accordingly.

### External Amplifier

The FlexMax's internal 50 watt amp is fairly loud, but if you're looking to fill a large room with a big scary monster's deep voice it's not going to cut it. Use an external amplifier in these situations.

### BooBox Audio

If you want the ability to use the FlexMax's internal MP3 player to play background audio, or even to run the character in an operator-free mode, you need the ability to play BooBox Audio.

### Voice Transformation

These diagrams use a Rolan VT-3 to transform the operator's voice in real-time. Any voice can be made to sound like a large monster, robot, or other character using this device.

## Example Diagrams

### Basic Setup

Can be used with or without an external amplifier.  
WITH amplifier: Microphone audio only (no BooBox Audio).  
WITHOUT amplifier: Microphone and BooBox audio can be heard.

### Amplified Setup

- Hear microphone and BooBox Audio through an external amp.

### Amplified Vocal Transformation with NO BooBox Audio

- Microphone audio is transformed into Monster, Robot, etc.  
- Only the Microphone audio will be amplified (no BooBox Audio).  
- External Amp Only.

### Amplified Vocal Transformation with BooBox Audio

- Same as Better Setup but with voice transformation.



# Basic Setup

## FLEXMAX



## BEHRINGER UB502 MIXER

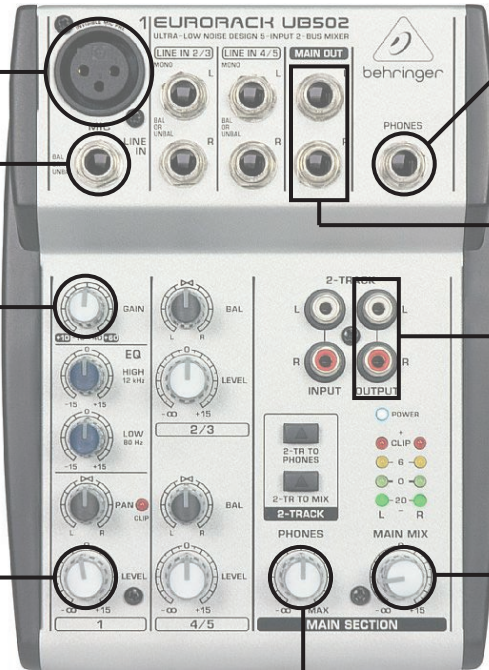

**WIRELESS OR HANDHELD MIC**

SET THE MIC GAIN AND VOLUME THEN LEAVE THEM ALONE. FURTHER ADJUSTMENTS WILL EFFECT MOUTH MOVEMENT.

**MIC GAIN**

**MIC VOLUME**  
USE THIS KNOB TO ADJUST THE AUDIO LEVEL BEING SENT TO THE BOOBOX WHICH WILL GREATLY EFFECT HOW THE MOUTH MOVES.

**PHONES VOLUME**  
USE THIS KNOB TO ADJUST THE AUDIO LEVEL BEING SENT TO THE BOOBOX WHICH WILL GREATLY EFFECT HOW THE MOUTH MOVES.



**MASTER VOLUME**  
USE THIS KNOB TO ADJUST THE MIC VOLUME AT THE SPEAKERS WITHOUT AFFECTING MOUTH MOVEMENT.

**POWERED SPEAKERS OR AMPLIFIER**



## Vocal Transformation with BooBox Audio

### FLEXMAX



POWERED SPEAKERS OR AMPLIFIER

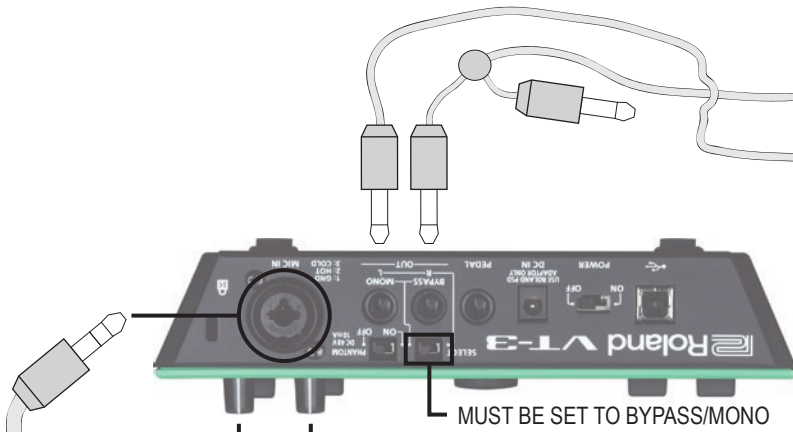

MUST BE SET TO BYPASS/MONO

#### MOUTH SENSITIVITY

SET THE MIC SENS KNOB TO THE POINT JUST BEFORE THE PEAK LED LIGHTS WHILE USING THE MIC. THEN USE THE VOLUME KNOB TO ADJUST HOW MUCH THE MOUTH MOVES DURING SPEECH. SENSITIVITY MAY NEED TO BE ADJUSTED FOR EACH OPERATOR.



WIRELESS OR HANDHELD MIC



#### FLEXMAX MP3 VOLUME

USE THIS KNOB TO ADJUST THE VOLUME LEVEL FOR ANY AUDIO COMING FROM THE FLEXMAX.

#### MIC VOLUME

USE THIS KNOB TO ADJUST THE VOLUME LEVEL OF THE MIC WITHOUT AFFECTING THE MOUTH MOVEMENT. THE GAIN KNOB ABOVE CAN ALSO BE USED TO ADJUST THE MAX VOLUME.

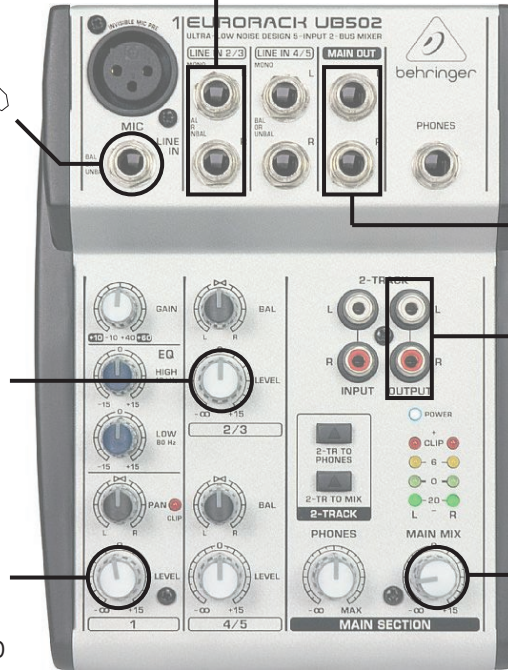

BEHRINGER UB502 MIXER

OR

MASTER VOLUME  
USE THIS KNOB TO ADJUST THE OVERALL VOLUME OF BOTH THE MIC AND THE FLEXMAX.