

Sensor Dimensions

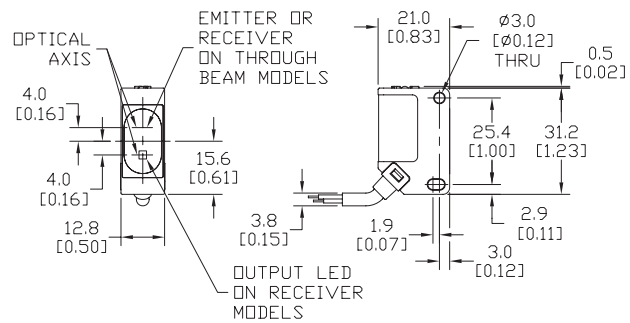

Diffuse Beam Sensor

617

www.frightideas.com

Bracket Dimensions

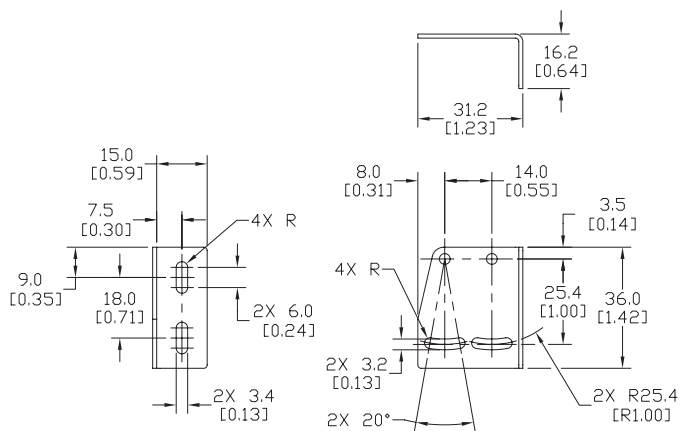

Instructions

The sensing range will vary based on the reflectivity of the object. We've measured about 4 feet with a black shirt and 5.5 feet with a white shirt.

If you want the maximum sensing range turn the sensitivity adjustment fully clockwise to maximum.

If you have a wall or other object opposite the sensor that you do NOT want to detect you may have to lower the sensitivity. Place a typical object in the sensor's path. Start with the sensitivity all the way down. Then turn it up until the green light comes on.

Light On / Dark On

The sensor's output can turn on when the sensor senses an object (Light On) or when it does NOT sense an object (Dark On). If the sensor is triggering the controller's input when the object is removed from the sensor's view, try another changing output modes by turning the "1" screw shown below.

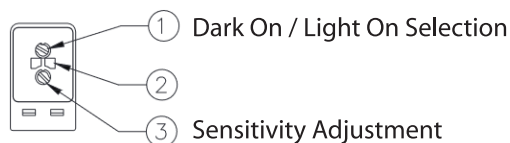

Specs and Connections

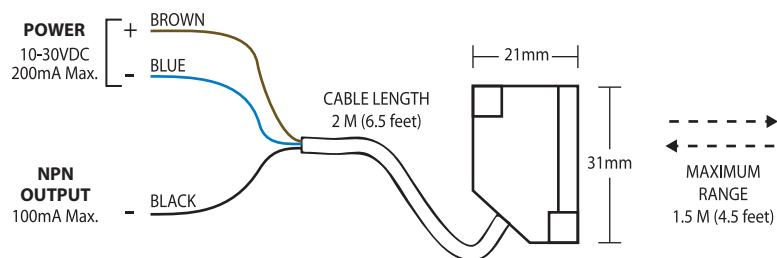

BooTunes, Flex, and FlexMax Wiring

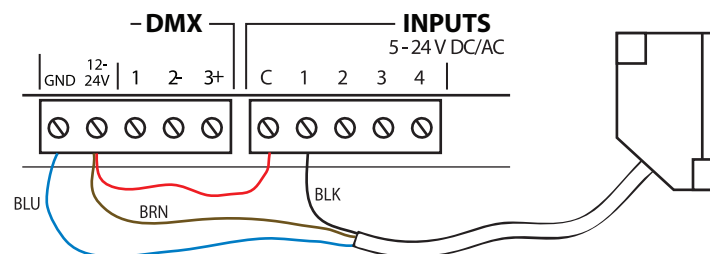

PicoBoo and PicoFX Wiring

